

# Osby Parca EL 36/50 Eco

– A new generation of electric boilers 36 - 50 kW.

The Professional's Choice Since 1935



**New!**

- ✓ Reliable and affordable
- ✓ Separate **TOUCH SCREEN**
- ✓ Backup via USB
- ✓ Tariff control
- ✓ Prepared for connection to solar collectors
- ✓ Eco represents **HIGH QUALITY** and low maintenance costs.
- ✓ Communication via MODbus, Profibus, RS485 and Ethernet
- ✓ Alerts via **BMS SYSTEM, GSM MODULE** or relay output
- ✓ Operating history and alarm with **TROUBLESHOOTING TEXT**
- ✓ Simple output limitation in % (the system calculates the number of stages automatically)



Eco series touch screen

## Dimensions & Connections EL 36 & 50 Eco

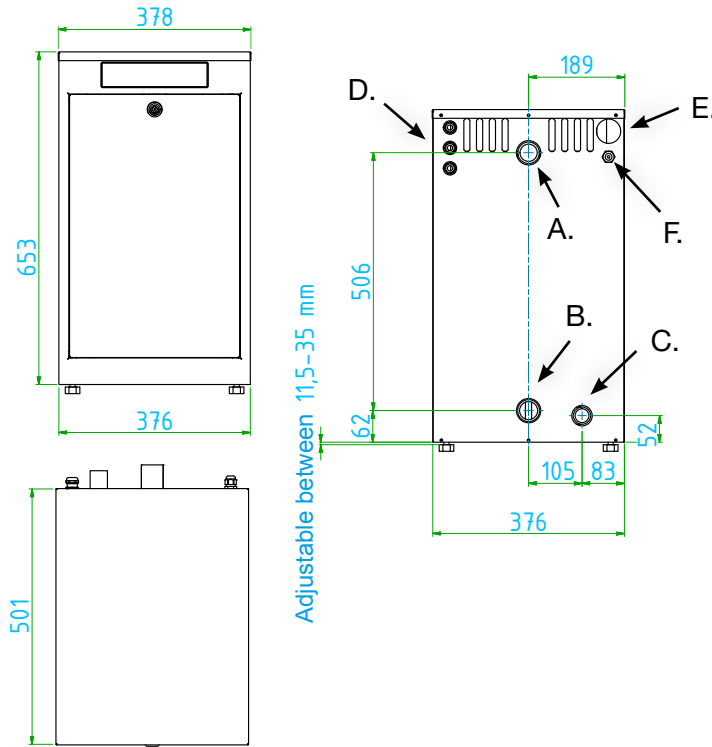

- A. Supply flow conn. 32 (ext. thread)
- B. Return flow conn. 32 (ext. thread)
- C. Drainage R1" ext.
- D. Connection slot 3 x PG11
- E. Conn. slot 400 V 1 x Ø 48 mm
- F. Conn. slot 230 V

Separate power supply 230 V 1 ~ required for operating voltage.  
The touch screen is delivered separately (incl. 3 m cable).

### Accessories:

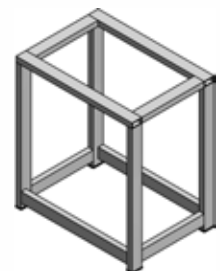

1.



2.



3.



4.



5.

### Design data – EL 36 & 50 Eco

Design pressure	4.0 bar
Testing pressure	5.7 bar
Design temperature	110 °C
Max. operating temperature	100 °C
Boiler water volume	24 litres
Protection class	IP21

### Accessories Eco-series electric boilers

Art. No.	Image	Designation
7641437-01	1	Stand for EL 36/50 Eco
3366-9005	2	GSM Alarm with battery back-up
584196401	3	Outdoor temperature sensor incl. 15 m cable
585513301	4	BMS / Internet module
1118404-01	5	3 current sensors for secondary measurement, max. 5A. Excl. current transformer

### Technical data - EL 36 & 50 Eco

Art. No	RSK-Number	Output	1:st Step	Steps	Voltage	Current	Main fuse	Weight (excl. water)
		kW	kW	Antal	V	A	A	kg
7700110-01	620 38 13	36	5,2	7	400 V	52	63	40
7700110-11	*	36	5,2	7	230 V	90	100	40
7700120-01	620 38 26	50	8,3	6	400 V	72	80	40
7700120-11	*	50	8,3	6	230 V	125	160	40

\* Only for the Norwegian market

Subject to errors or updates to the boiler after 10/08/2018